

PrimeLock® Fitting

Tube removal from PrimeLock fittings

Care must be taken when disassembling PrimeLock® fittings. Follow these instructions precisely to avoid fitting disassembly issues.

As shown in the example below, rotate the tube in a circular motion and slowly extract the tube with the insert from the nose

of the PrimeLock fitting. If the tube is not rotated, the insert may disengage from the inside of the tubing and remain on the nose of the fitting.

Follow these steps to properly remove the tube from a fully installed PrimeLock fitting:

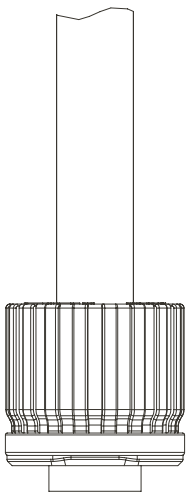

A properly tightened fitting

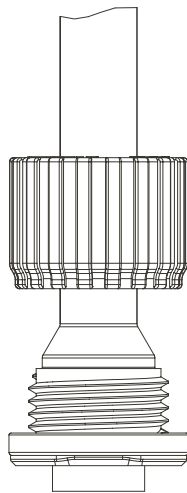

Loosen the fitting nut from the fitting body

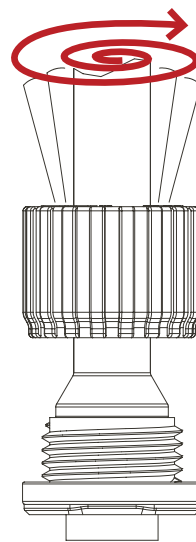

Rotate the tube in a circular motion, gradually making the circular motions larger. This will help dislodge the tubing and insert from the fitting body

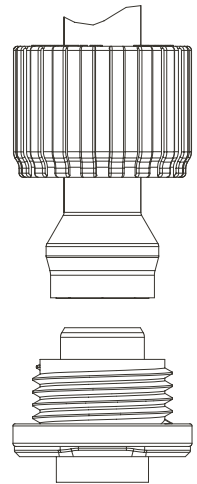

Fully extract the tube with the insert staying in the tube

If the insert remains on the nose of the PrimeLock fitting, carefully remove the insert without damaging the fitting nose and discard. Install a new insert into the tube. Reusing a PrimeLock insert may cause sealing issues.

TERMS AND CONDITIONS OF SALE

All purchases are subject to Entegris' Terms and Conditions of Sale. To view and print this information, visit entegris.com and select the Terms and Conditions link in the footer.



Corporate Headquarters
129 Concord Road
Billerica, MA 01821
USA

Customer Service
Tel +1 952 556 4181
Fax +1 952 556 8022
Toll Free 800 394 4083

Entegris®, the Entegris Rings Design™, Pure Advantage and PrimeLock® are trademarks of Entegris, Inc.
©2016 Entegris, Inc. | All rights reserved. | Printed in the USA | 3110-8163ENT-0816